

## Load Hook HS/S Grade 10 - Eye/Latch

### Product information



Eye Load hook - Sling hook with safety latch for general lifting applications... [Read more](#)

**Material:** Alloy steel.

**Marking:** According to standard, CE-marked

**Temperature range:** -40°C up to 380°C

**Finish:** Violet powder coated.

**Standard:** EN 1677-2 (+25% WLL)

**Warning:** Not to be heat-treated.

**Safety factor:** 4:1

**Grade:** 10

## Load Hook HS/S Grade 10 - Eye/Latch

### Blueprint

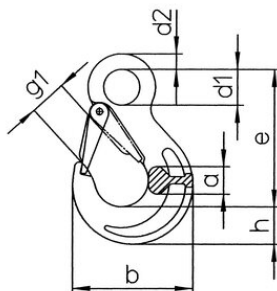

### Technical data

Part code	Code	Chain diameter mm	WLL ton	EWL mm	a mm	b mm	d1 mm	d2 mm	e mm	g1mm mm	h mm	Weight kg
402300140420	HS/S-6-10	6	1.4	85	17	68	20	10	85	19	21	0.29
402300250420	HS/S-7/8-10	7-8	2.5	106	19	88	25	11	106	26	27	0.57
402300400420	HS/S-10-10	10	4	131	26	109	34	16	131	31	33	1.19
402300670420	HS/S-13-10	13	6.7	164	33	134	43	19	164	39	44	1.96
402301000420	HS/S-16-10	16	10	183	40	155	50	25	183	45	50	3.85
402301600420	HS/S-19/20-10	19	16	205	48	178	55	27	205	53	55	5.92
402301900420	HS/S-22-10	22	19	225	50	196	60	29	225	62	62	7.65
402302650420	HS/S-26-10	26	26.5	259	70	235	70	37	259	73	75	12.76