

## Master Link Assemblies G/S Grade 10

---

### Product information

Master link sub-assembly.

... [Read more](#)

---



**Material:** Alloy steel

**Marking:** Code and grade.

**Finish:** Violet powder coated.

**Warning:** Not to be heat-treated.

**Safety factor:** 4:1

**Grade:** 10

## Master Link Assemblies G/S Grade 10

### Blueprint

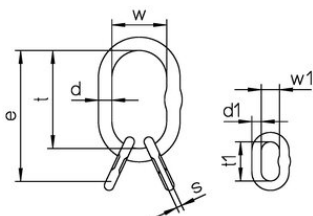

### Technical data

Part code	Code	Chain diameter mm	WLL ton	d mm	d1 mm	e mm	t mm	t1 mm mm	s mm	w mm mm	w1mm mm	Weight kg
402100420250	G/S-6	6	4.2	19	13	189	135	54	10	75	25	1.28
402100760250	G/S-7/8	7-8	7.6	23	17	230	160	70	14	90	34	2.37
402100960250	G/S-10	10	9.6	27	20	265	180	85	14	100	40	3.75
402101400250	G/S-13	13	14	33	23	315	200	115	17	110	50	6.6
402102120250	G/S-16	16	21.2	36	27	400	260	140	20	140	65	10.06
402103410250	G/S-19/20	19	34.1	50	33	500	350	150	26	190	70	22.87
402104000250	G/S-22	22	40	50	36	520	350	170	-	190	75	24.79
402105600250	G/S-26	26	56	56	45	570	400	170	-	200	80	37.6