

## Starcon Ring Clutch

### Product information

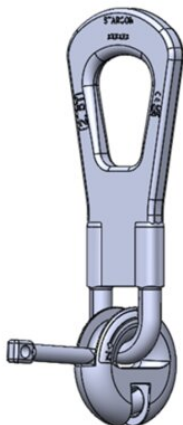

The Starcon ring clutch is a specially designed component with a bolt-shaped ring that grips the hole of the Starcon STA anchor. It enables quick and secure mounting of the ring coupling to the STA anchors by means of a locking bolt that mechanically locks to the anchor.

The ring coupling can be easily connected to a sling or hook, making lifting both fast and safe. It is ideal for use with lifting equipment and cranes, ensuring efficient and reliable handling of concrete elements.

**Areas of application:** The Starcon ring clutch is used for lifting Starcon STA anchors

**Advantages:** Ensures handling of concrete elements.

Enables safe lifting in all directions.

Quick and easy installation.

**Load group:** 2.5t – 10t

**Technical information:** CE marking according to MD 2006/42 EF

Starcon product is designed according to EN13155-2009 and follows the guidelines of VDI/BV-BS 6205 and DS/CEN/TR 15728. [... Read more](#)

**Marking:** CE-marked, batch code, load group + S(Starcon)

**Finish:** Electro-galvanized - Corrosion class C3 - ISO 12944-2.

## Starcon Ring Clutch

### Blueprint

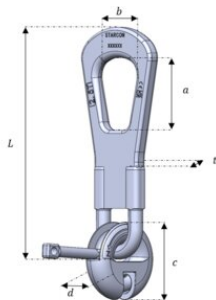

### Technical data

Part code	Load grp. t	a mm	b mm	c mm	d mm	t mm	L mm	Weight kg
650290025001	2.5	70	54	79	27	12.5	223	0.95
650290050001	5	85	59.5	107	37	17	281	1.5
650290100001	10	110	82.5	148	50	25	352	3.18