

Double Swivel Shackle Codipro SS DSS

Product information



The SS.DSS stainless steel lifting ring is a double swivel ring. It is specially designed for simultaneously lifting and rotating loads. Its double swivel action ensures perfect alignment with the sling.

Features:

- Stainless steel ring that provides maximum corrosion resistance.
- Rotatable under load.
- M45 to M56 or UNC thread available on request.

[... Read more](#)

Material: AISI 316 L

Marking: According to standard, CE-marked

Temperature range: -20°C up to + 200°C

Standard: EN 1677-1
except grade/WLL

Safety factor: 5:1

Double Swivel Shackle Codipro SS DSS

Blueprint

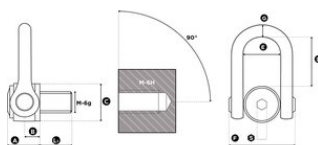

Technical data

Part code	WLL ton	Thread	Torque Nm	Standard L1 mm	A mm	B mm	C mm	D, mm	E mm	F mm	G, mm	L1mm mm	S mm	Weight kg
4215SSDSSM24	2.7	M 24 (x3)	160	36	61	31	70	98	73	149	30	36	19	5.2
4215SSDSSM30	3.5	M 30 (x3.5)	250	45	61	31	70	98	73	149	30	45	19	5.2
4215SSDSSM33	3.5	M 33 (x3.5)	250	50	61	31	70	98	73	149	30	50	19	5.2
4215SSDSSM36	5	M 36 (x4)	320	54	61	31	70	98	73	149	30	54	19	5.2
4215SSDSSM36x3	5	M 36 (x3)	320	54	61	31	70	98	73	149	30	54	19	5.2
4215SSDSSM39	5	M 39 (x4)	320	54	61	31	70	98	73	149	30	54	19	5.4
4215SSDSSM42	6	M 42 (x4,5)	400	63	61	31	70	98	73	149	30	63	19	5.4
4215SSDSSM42x3	6	M 42 (x3)	400	63	61	31	70	98	73	149	30	63	19	5.4