

Open Wedge Socket OWS B with Bolt

Product information



Intended for attaching of wire rope where switching often occur, e.g. blocks of mobilecranes, or to be able to adjust the length of the wire rope. See recommended assembly to get correct results.

The wedge socket is delivered complete with wedge, bolt, nut and cotterpin.

2 surface finishes available:

- Model OWS B: blue painted.
- Model OWS BGAL: Hot dipped galvanized.

Model OWS 0.25 and OWS 0.5 only standard available in hot dipped galvanized ... [Read more](#)

Material: Quenched and tempered cast steel.

Marking: Size, wire rope diameter and batch or serial number.

Temperature range: -40°C to + 110°C - Use at higher temperatures possible with reduction of WLL.

Finish: Blue painting or hot dipped galvanized.

Note: The efficiency of a 6 and 8 strand wire rope/wedge socket connection is 80% of the minimum breaking load of the wire but limited to the minimum breaking load of the socket (MBL).

Open Wedge Socket OWS B with Bolt

Blueprint

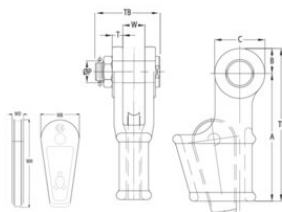

Technical data

| Part code | Rope Ø range mm | MBL ton | Finish | A mm | B mm | C mm | øP mm mm | T mm | TLmm mm | TB mm | W mm | WH mm mm | WB mm mm | WD mm mm | Weight kg |
|--------------|-----------------|---------|------------|------|------|------|----------|------|---------|-------|------|----------|----------|----------|-----------|
| 121500800212 | 7-8 | 8 | Galvanized | 110 | 18 | 36 | 16 | 9 | 128 | 62 | 18 | 70 | 35 | 9 | 0.8 |
| 121501000212 | 9-10 | 12 | Galvanized | 145 | 23 | 46 | 21 | 11 | 168 | 75 | 21 | 74 | 36 | 12 | 1.7 |
| 121501300215 | 11-13 | 20 | Painted | 157 | 29 | 57 | 25 | 12 | 185 | 80 | 25 | 115 | 48 | 14 | 2.1 |
| 121501300212 | 11-13 | 20 | Galvanized | 157 | 29 | 57 | 25 | 12 | 185 | 80 | 25 | 115 | 48 | 14 | 2.1 |
| 121501600215 | 14-16 | 25 | Painted | 190 | 35 | 70 | 30 | 15 | 225 | 96 | 31 | 135 | 57 | 18 | 4 |
| 121501600212 | 14-16 | 25 | Galvanized | 190 | 35 | 70 | 30 | 15 | 225 | 96 | 31 | 135 | 57 | 18 | 4 |
| 121501900215 | 18-19 | 40 | Painted | 210 | 40 | 80 | 35 | 16 | 250 | 107 | 38 | 160 | 70 | 21 | 7 |
| 121501900212 | 18-19 | 40 | Galvanized | 210 | 40 | 80 | 35 | 16 | 250 | 107 | 38 | 160 | 70 | 21 | 7 |
| 121502200215 | 20-22 | 55 | Painted | 252 | 48 | 95 | 41 | 18 | 300 | 123 | 44 | 187 | 77 | 24 | 10 |
| 121502200212 | 20-22 | 55 | Galvanized | 252 | 48 | 95 | 41 | 18 | 300 | 123 | 44 | 187 | 77 | 24 | 10 |
| 121502600215 | 23-26 | 75 | Painted | 298 | 55 | 110 | 51 | 22 | 353 | 141 | 51 | 212 | 83 | 28 | 15 |
| 121502600212 | 23-26 | 75 | Galvanized | 298 | 55 | 110 | 51 | 22 | 353 | 141 | 51 | 212 | 83 | 28 | 15 |
| 121502900215 | 27-29 | 90 | Painted | 322 | 65 | 130 | 57 | 25 | 387 | 160 | 57 | 232 | 91 | 30 | 21 |
| 121502900212 | 27-29 | 90 | Galvanized | 322 | 65 | 130 | 57 | 25 | 387 | 160 | 57 | 232 | 91 | 30 | 21 |
| 121503200215 | 30-32 | 110 | Painted | 350 | 73 | 146 | 63 | 28 | 423 | 165 | 63 | 266 | 108 | 33 | 31 |
| 121503200212 | 30-32 | 110 | Galvanized | 350 | 73 | 146 | 63 | 28 | 423 | 165 | 63 | 266 | 108 | 33 | 31 |
| 121503600215 | 34-36 | 125 | Painted | 400 | 74 | 148 | 64 | 28 | 474 | 185 | 70 | 298 | 116 | 35 | 37 |
| 121503600212 | 34-36 | 125 | Galvanized | 400 | 74 | 148 | 64 | 28 | 474 | 185 | 70 | 298 | 116 | 35 | 37 |
| 121503900215 | 37-39 | 150 | Painted | 450 | 80 | 142 | 70 | 30 | 530 | 210 | 77 | 338 | 130 | 38 | 51 |
| 121503900212 | 37-39 | 150 | Galvanized | 450 | 80 | 142 | 70 | 30 | 530 | 210 | 77 | 338 | 130 | 38 | 51 |
| 121504200215 | 40-42 | 170 | Painted | 500 | 87 | 160 | 76 | 33 | 587 | 209 | 76 | 373 | 140 | 41 | 64 |
| 121504200212 | 40-42 | 170 | Galvanized | 500 | 87 | 160 | 76 | 33 | 587 | 209 | 76 | 373 | 140 | 41 | 64 |

Open Wedge Socket OWS B with Bolt

Technical data

| Part code | Rope \emptyset range mm | MBL ton | Finish | A mm | B mm | C mm | $\emptyset P$ mm | T mm | TLmm mm | TB mm | W mm | WH mm mm | WB mm mm | WD mm mm | Weight kg |
|--------------|---------------------------|---------|------------|-------|------|------|------------------|------|---------|-------|------|----------|----------|----------|-----------|
| 121504800215 | 43-48 | 225 | Painted | 550 | 100 | 186 | 89 | 39 | 650 | 237 | 89 | 408 | 146 | 48 | 96 |
| 121504800212 | 43-48 | 225 | Galvanized | 550 | 100 | 186 | 89 | 39 | 650 | 237 | 89 | 408 | 146 | 48 | 96 |
| 121505200215 | 49-52 | 280 | Painted | 637 | 105 | 205 | 95 | 46 | 740 | 263 | 101 | 450 | 160 | 53 | 130 |
| 121505200212 | 49-52 | 280 | Galvanized | 637 | 105 | 205 | 95 | 46 | 740 | 263 | 101 | 450 | 160 | 53 | 130 |
| 121505800215 | 54-58 | 360 | Painted | 660 | 125 | 250 | 108 | 54 | 785 | 298 | 114 | 470 | 168 | 58 | 180 |
| 121505800212 | 54-58 | 360 | Galvanized | 660 | 125 | 250 | 108 | 54 | 785 | 298 | 114 | 470 | 168 | 58 | 180 |
| 121506800215 | 60-68 | 425 | Painted | 835 | 135 | 270 | 121 | 60 | 970 | 330 | 127 | 500 | 176 | 65 | 275 |
| 121506800212 | 60-68 | 425 | Galvanized | 835 | 135 | 270 | 121 | 60 | 970 | 330 | 127 | 500 | 176 | 65 | 275 |
| 121507600215 | 72-76 | 460 | Painted | 1,000 | 150 | 300 | 133 | 76 | 1,150 | 380 | 146 | 550 | 244 | 70 | 440 |
| 121507600212 | 72-76 | 460 | Galvanized | 1,000 | 150 | 300 | 133 | 76 | 1,150 | 380 | 146 | 550 | 244 | 70 | 440 |
| 121508600215 | 81-86 | 625 | Painted | 1,160 | 150 | 300 | 140 | 79 | 1,310 | 397 | 159 | 670 | 260 | 80 | 510 |
| 121508600212 | 81-86 | 625 | Galvanized | 1,160 | 150 | 300 | 140 | 79 | 1,310 | 397 | 159 | 670 | 260 | 80 | 510 |