

## Snatch Block S - Schackle | Discontinued

---

### Product information



**General:** Intended for general lifting purposes. Can also be used for pulling. WLL in table applies for load on head fitting/shackle.

**Features:**

- Snatch block type with covering side plates.
- Provided with swiveling bow shackle.
- Grease fitting in the shaft and cross head.
- Bronze bushed sheave in 2-4 tons blocks and roller bearings in larger sizes [... Read more](#)

---

**Material:** Steel.

**Marking:** Type, WLL and wire rope diameter.

**Finish:** Blue painted.

## Snatch Block S - Schackle | Discontinued

### Blueprint

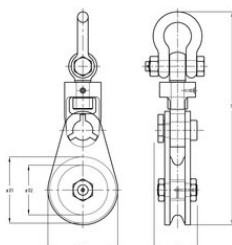

### Technical data

Part code	Rope Ø range	WLL ton	TA mm	TB mm	TC mm mm	Ø D1 mm mm	Ø D2 mm mm	Weight kg
424100200080	7-9	2	82	70	290	75	58	4
424100400080	10-12	4	120	70	358	115	90	6
424100400085	16-19	4	160	70	432	150	120	14
424100800088	19-22	8	160	93	497	150	120	15
424100800080	19-22	8	210	93	550	200	165	16
424101000080	24-26	10	260	115	681	250	205	38
424101200089	24-26	12	260	115	683	250	205	42
424101200080	24-26	12	310	133	767	300	250	56
424101500087	22-24	15	210	102	663	200	165	24
424101500080	24-26	15	310	133	788	300	250	65
424102200080	28-32	22	365	140	962	355	305	90
424102200086	28-32	22	415	140	1,019	405	350	108
424102200085	28-32	22	465	180	1,069	450	395	120
424103000080	28-30	30	310	193	1,023	300	245	125
424103000086	32-35	30	415	155	1,121	405	350	135
424103000086	32-35	30	514	162	1,256	508	440	210
424103500080	32-35	35	365	193	1,058	350	280	130
424105000080	46-50	50	625	275	1,525	600	500	418