

Shackles, SAE - dee mode with locking

Product information



Shackles approved for lifting. Dee shackles are suitable for use when two pieces of lifting equipment / an installment are joined together (one-leg systems). Locking bolt shackles are recommended for long-term and permanent installations, or when there is a natural tendency for the pin to unscrew (rotate) in the application, or when the shackle cannot be observed under operation.

... [Read more](#)

Features: RFID-ready

Material: Steel

Marking: According to standard, CE-marked

Temperature range: -20°C - (+)200°C

Finish: Hot dip galvanized

Standard: US. FED. SPEC. RR-C-271F

Safety factor: 6:1

Shackles, SAE - dee mode with locking

Blueprint

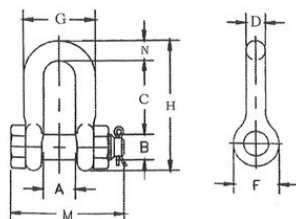

Technical data

Part code	WLL ton	Size inch	A mm	B mm	C mm	D mm	F mm	G, mm	H, mm	Mmm mm	Nmm mm	Weight kg
420100050750	0.5	1/4	12	8	19	7	16	25	41	40	7	0.06
420100750750	0.75	5/16	14	10	26	8	19	30	49	46	8	0.1
420100100750	1	3/8	17	11	31	10	23	36	59	55	10	0.15
420100150750	1.5	7/16	19	13	36	11	27	41	68	64	11	0.22
420100200750	2	1/2	21	16	42	13	30	46	77	71	13	0.34
420100330750	3.25	5/8	27	19	51	16	38	59	96	90	16	0.67
420100480750	4.75	3/4	32	23	61	19	46	70	115	103	21	1.14
420100650750	6.5	7/8	37	26	72	23	53	81	135	120	25	1.74
420100850750	8.5	1	43	29	81	26	61	94	151	135	26	2.52
420100950750	9.5	1-1/8	46	32	91	29	69	103	172	150	32	3.45
420101200750	12	1-1/4	52	35	100	32	76	115	191	165	35	4.9
420101350750	13.5	1-3/8	57	38	111	35	84	127	210	183	38	6.24
420101700750	17	1-1/2	61	42	122	38	92	137	230	196	42	8.39
420102500750	25	1-3/4	73	51	146	45	106	162	279	230	54	14.2
420103500750	35	2	82	57	172	51	122	184	312	264	51	21.2
420105500750	55	2-1/2	105	70	203	67	145	238	377	344	67	38.6
420108500750	85	3	127	83	216	76	165	279	429	419	89	56
420112000750	120	3-1/2	133	96	240	92	203	320	500	510	102	95