

Alloy Bolt Type Anchor Shackle Crosby G-2140

Product information

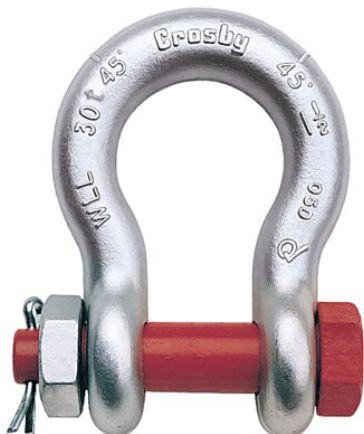

Shackle with bolt and nut. All sizes are individually proof loaded 2 x WLL

Standard: US Fed. Spec. RR-C-271F/ approved according to DNV 2.7-1.

Safety Factor: 4,5:1 on sizes 2-21t, 5,4:1 on sizes 30-175t and 4:1 on sizes 200-400t.

... [Read more](#)

Material: Alloy steel.

Marking: According to standard, CE-marked, WLL, batchnumber, serial number on sizes exceeding 200 tons, angle indicator 45°, RFID on all sizes.

Finish: Galvanized with painted bolt.

Standard: US. FED. SPEC. RR-C-271, ASME B30.26

Note: Specially ordered shackles can be marked and supplied with documentation according to DNV and Lloyds, or other certifying unit.

Grade: 8

Alloy Bolt Type Anchor Shackle Crosby G-2140

Blueprint

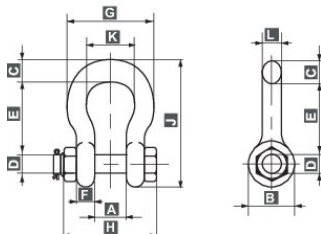

Alloy Bolt Type Anchor Shackle Crosby G-2140

Technical data

Part code	Code	WLL ton	A mm	B mm	C mm	D mm	E mm	F mm	G mm	H mm	J mm	K mm	L mm	A Tolerance +/- mm	D Tolerance +/- mm	E Tolerance +/- mm	Weight kg
420100200270	G2140-2	2	16.8	23.1	9.7	11.2	36.6	9.7	45.2	55.1	63.2	26.2	9.7	1.5	0.3	3.3	0.15
420100270270	G2140-2,6	2.66	19.1	26.9	11.2	12.7	42.9	10.4	51.6	63.8	73.9	29.5	11.2	1.5	0.3	3.3	0.22
420100330270	G2140-3,3	3.33	20.6	30.2	12.7	16.3	47.8	11.7	58.7	71.1	83.3	33.3	12.7	1.5	0.5	3.3	0.36
420100500270	G2140-5	5	26.9	38.1	17.5	19.6	60.5	14.7	74.7	90.4	106.4	42.9	16	1.5	0.5	3.3	0.76
420100700270	G2140-7	7	31.8	46	20.6	22.6	71.4	17.5	88.9	105.4	126.2	50.8	19.1	1.5	0.5	6.4	1.23
420100950270	G2140-9,3	9.5	36.6	53.1	24.6	25.9	84.1	20.6	102.4	122.4	148.1	57.9	22.4	1.5	0.5	6.4	1.79
420101250270	G2140-12,3	12.5	42.9	60.5	26.9	29.2	95.3	23.4	119.1	136.9	166.6	68.3	25.4	1.5	0.5	6.4	2.57
420101500270	G2140-15	15	46	68.3	31.8	31.8	108	26.4	131.1	149.9	189.7	73.9	28.7	1.5	0.5	6.4	3.75
420101800270	G2140-18	18	51.6	76.2	35.1	35.6	119.1	29.5	146.1	169.9	209.6	82.6	32.8	1.5	0.8	6.4	5.31
420102100270	G2140-21	21	57.2	84.1	38.1	38.9	133.4	32.5	162.1	183.1	232.7	92.2	36.1	3.3	0.8	6.4	7.17
420103000270	G2140-30	30	60.5	91.9	41.1	41.4	146	35.3	175	196	254	98.6	38.9	3.3	0.8	6.4	8.53
420104000270	G2140-40	40	73.2	106	57.2	50.8	178	44.5	224	237	313	127	46.7	3.3	0.8	6.4	15.3
420105500270	G2140-55	55	82.6	122	61	57.2	197	50.8	258	264	347	146	52.8	3.3	0.8	6.4	22.6
420108500270	G2140-85	85	105	148	79.2	69.9	267	66.5	324	345	455	184	68.8	6.4	0.8	6.4	46.7
420112000270	G2140-120*	120	127	165	92.2	82.6	330	76.2	371	384	546	200	79.2	6.4	1	6.4	73.5
420115000270	G2140-150*	150	133	203	111	95.3	372	95.3	432	448	632	229	91.9	6.4	0.3	6.4	122
420117500270	G2140-175*	175	140	229	116	108	368	102	457	517	652	254	102	6.4	0.3	6.4	144
420120000270	G2140-200**	200	184	267	127	121	386	116	529	611	706	279	121	6.4	0.3	6.35	209
420125000270	G2140-250**	250	216	305	143	127	470	123	600	632	828	330	127	4	0.3	1.8	276
420130000270	G2140-300**	300	213	330	154	152	475	124	629	666	871	330	149	4	0.3	1.8	362
420140000270	G2140-400**	400	210	356	184	178	572	165	660	728	1,022	330	152	6.4	0.3	6.4	585