

## Quick Lift Double Swivel Ring QL DSR

### Informacja o produkcie



The QLR is a double swivel ring that allows particularly fast anchoring. At the push of a button, it can be fixed in the threaded hole in a matter of seconds. Its double swivel ensures a perfect alignment with the sling.

The QL.DSR saves up to 80 % of time compared to screwing in a conventional lifting ring. The system works purely mechanically and thus requires no complex maintenance.

The swivel lifting ring QL.DSR is made of gradup steel, which stands for a better quality of the used raw materials. It has higher lifting capacities than fixed rings and has a safety factor of 5, which means that its breaking load is five times greater than the capacity indicated in the technical data sheet.

Complies with the Machinery Directive 2006/42/CE

[... Read more](#)

**Znakowanie:** zgodnie z normą, oznaczenie CE

**standard:** EN 1677-1

*Except grade and safety factor*

**Współczynnik bezpieczeństwa:** 5:1

## Quick Lift Double Swivel Ring QL DSR

### Rysunek techniczny

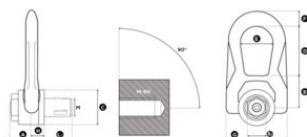

### Dane techniczne

Nr artykułu	DOR ton	Gwint mm	nachylenie mm	Moment obrotowy Nm	A mm	B mm	C mm	D mm	E mm	F mm	G mm	H mm	L1 mm	S2 mm	M mm	Waga kg
4215QLDSRM8	0,25	M 8	1,25	20	31	30	30	38	27	14	53	9,5	17,5	18	M 8	0,3
4215QLDSRM10	0,4	M 10	1,5	30	31	30	30	38	27	14	53	9,5	19,5	18	M 10	0,3
4215QLDSRM12	0,65	M 12	1,75	60	40	40	45	53	38	17	76	13	23	27	M 12	0,9
4215QLDSRM14	0,7	M 14	2	80	40	40	45	53	38	17	76	13	23	27	M 14	0,9
4215QLDSRM16	1,05	M 16	2	100	40	40	45	53	38	17	76	13	27	27	M 16	0,9
4215QLDSRM20	1,7	M 20	2,5	160	55	55	60	83	55	25	115	19	30	40	M 20	2,6
4215QLDSRM24	2,5	M 24	3	180	55	55	60	83	55	25	115	19	36	40	M 24	2,6