



## Lifting Eye Nut RUD RM

### Product information

Octagonal lifting eye approved for lifting. Lifting with an angle of inclination is allowed with reduction of WLL (see diagram at blueprint) but we strongly recommend using the RUD RM lifting eye only for straight lifting.

Applied harmonized norms: DIN EN ISO 12100: 2011-03

**Marking:** According to standard, CE-marked

**Standard:** EN 1677-1

**Safety factor:** 4:1

**Класс:** 8

| Код товара   | WLL ton | Thread mm | WLL 90° ton | A, | B, | C, | D, | E,  | T mm | Вес kg |
|--------------|---------|-----------|-------------|----|----|----|----|-----|------|--------|
| 421100040230 | 0,4     | M6        | 0,1         | 12 | 11 | 10 | 25 | 25  | 34   | 0,1    |
| 421100080230 | 0,8     | M8        | 0,2         | 12 | 11 | 10 | 25 | 25  | 34   | 0,1    |
| 421100100230 | 1       | M10       | 0,25        | 12 | 11 | 10 | 25 | 25  | 34   | 0,1    |
| 421100160230 | 1,6     | M12       | 0,4         | 14 | 13 | 12 | 30 | 30  | 41   | 0,2    |
| 421100200230 | 3       | M14       | 0,75        | 16 | 15 | 14 | 35 | 35  | 48   | 0,3    |
| 421100320230 | 3,2     | M16       | 0,8         | 16 | 15 | 14 | 35 | 35  | 48   | 0,3    |
| 421100480230 | 4,8     | M18       | 1,2         | 18 | 17 | 16 | 40 | 40  | 55   | 0,4    |
| 421100600235 | 6       | M20       | 1,5         | 18 | 17 | 16 | 40 | 40  | 55   | 0,35   |
| 421100600230 | 6       | M22       | 1,5         | 22 | 21 | 20 | 50 | 50  | 70   | 0,65   |
| 421100800235 | 8       | M24       | 2           | 22 | 21 | 20 | 50 | 50  | 70   | 0,6    |
| 421100800230 | 8       | M27       | 2           | 28 | 26 | 24 | 60 | 60  | 85   | 1,4    |
| 421101200230 | 12      | M30       | 3           | 28 | 26 | 24 | 60 | 60  | 85   | 1,3    |
| 421101200235 | 12      | M33       | 3           | 37 | 43 | 38 | 90 | 100 | 130  | 5,8    |
| 421101600230 | 16      | M36       | 4           | 40 | 43 | 38 | 90 | 100 | 130  | 5,65   |
| 421102000230 | 20      | M39       | 5           | 37 | 43 | 38 | 90 | 100 | 130  | 5,65   |
| 421102400230 | 24      | M42       | 6           | 40 | 43 | 38 | 90 | 100 | 130  | 5,4    |
| 421103200230 | 32      | M48       | 8           | 40 | 43 | 38 | 90 | 100 | 130  | 5,3    |

# Blueprint

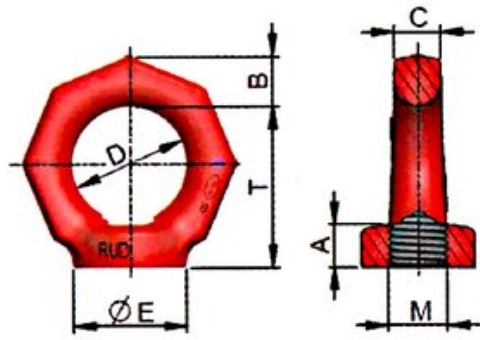

| Lifting Method               |    |      |    |
|------------------------------|----|------|----|
| Angle of inclination $\beta$ | 0° | 90°  | 0° |
| WLL Factor                   | 1  | 0.25 | 2  |

For these lifting methods we recommend lifting points which can be adjusted to the direction of pull!