

## Stainless steel lifting eye screw DIN 580

---

### Product information

Stainless steel lifting eye for vertical lifting.

... [Read more](#)



**Marking:** According to standard, CE-marked

**Standard:** DIN 580

**Safety factor:** 4:1

## Stainless steel lifting eye screw DIN 580

### Blueprint

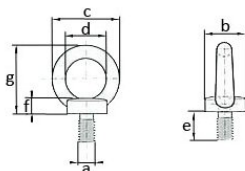

### Technical data

| Код товара   | WLL ton | Thread mm | b mm | c mm | d mm | e mm | f mm | g mm | Бec kg |
|--------------|---------|-----------|------|------|------|------|------|------|--------|
| 421100230500 | 0,23    | M10       | 25   | 45   | 25   | 17   | 8    | 45   | 0,11   |
| 421100340500 | 0,34    | M12       | 30   | 54   | 30   | 20,5 | 10   | 53   | 0,18   |
| 421100070500 | 0,7     | M16       | 35   | 63   | 35   | 27   | 12   | 62   | 0,28   |
| 421100120500 | 1,2     | M20       | 39   | 71   | 39   | 30   | 14   | 70   | 0,45   |