

Weld-on Point TAPS

Product information

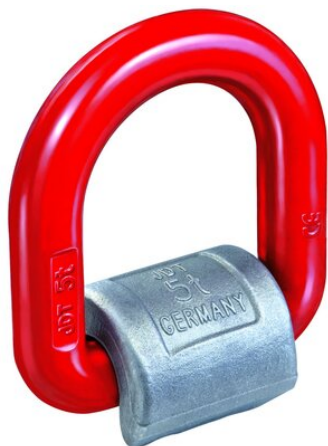

Weld-on lifting attachment point for plane surfaces.

- Compact design
- Secured four times against breakage
- Weld-on shackle made of material S355JR according to EN 10025
- Also loadable transversely to the swivel direction

... [Read more](#)

Marking: CE-marked

Safety factor: 4:1

Класс: 8

Weld-on Point TAPS

Blueprint

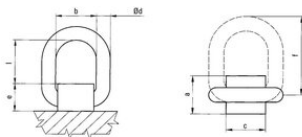

Technical data

Код товара	Код	WLL ton	a mm	b mm mm	c mm	Ø d mm	e mm mm	f mm mm	l mm mm	Вес kg
42150381701000	TAPS 1	1,12	35	64	35	13	26	70	40	0,35
42150381702000	TAPS 2	2	37	66	36	13	27	70	41	0,36
42150381703000	TAPS 3	3,15	49	92	50	18	37	92	53	0,84
42150381705000	TAPS 5	5,3	60	111	60	22	45	111	63	1,6
42150381708000	TAPS 8	8	75	132	70	26	50	127	68	2,61
42150380415000	TAPS 15	15	90	185	100	30	60	190	120	5,4