

# CHAIN, WIRE ROPE AND LEVER HOISTS AND TROLLEYS



[Electric chain hoists »](#)

[Compressed air hoists and winches »](#)

[Trolleys »](#)

[Lever hoists »](#)

[Hand chain hoists »](#)

[Wire rope / Strap pulling hoists »](#)

[Wire rope hoists »](#)

[Electric wire hoists »](#)



## RED ROOSTER AIR COMPRESSED HOISTS AND WINCHES

RED ROOSTER compressed air hoists and winches offer a wide selection for industrial and maritime use.

All Red Rooster hoists and winches comply with ATEX 94/9/EC directive and may be used in areas and surroundings with danger of fire or explosion due to gases, chemicals or dust. Red Rooster hoists and winches operate mechanically with compressed air hence causing no sparks unlike electric hoists.

Red Rooster hoists and winches have been used and developed for 25 years and they are safe, easy to use and they operate reliably even in difficult circumstances.

### Red Rooster hoists

- WLL 0,25 - 50,0 t
- no sparks
- strong molded steel case
- stepless speed control
- safe automatic brake, load cannot fall with loss of pressure
- low noise level (80 dB)
- low consumption of air
- operational pressure for all products 4,5 - 6 bar (7 bar max.)
- endures demanding circumstances
- operating temperature -10 - (+)70 °C, also -20 °C possible to actualize
- spare parts easy and fast to acquire
- wide selection of accessories, incl. radio-operated remote control



Special low models also available.

### Hoists with a hook suspension

WLL t	No. of chains	Amount of air when lifting l/sec	Amount of air when lowering l/sec	Lifting speed with full load m/min	Weight 3 m lift kg
0.25	1	13	15	9.3	7,0
0.25/0.5	1	25	27	12 / 10.5	9,0
0.5	2	13	15	4.6	19,0
0.5	1	28	33	17	31,1
0.98	2	28	33	8.5	23,5
1.0	2	25	27	5.3	35,2
1.0	1	25	28	6.0	34,0
2.0	2	25	30	3.0	39,7
3.0	1	33	43	2.8	69,0
6.0	2	33	43	1.4	91,0
9.0	3	33	43	0.9	150,0
10.0	2	90	100	1.5	210,0
12.0	4	33	43	0.6	170,0
15.0	5	33	43	0.5	210,0
15.0	3	90	100	1.0	320,0
20.0	4	90	100	0.75	470,0
25.0	2	90	100	0.6	490,0
37.5	3	90	100	0.35	870,0
50.0	4	90	100	0.3	1100,0

Lifting height to be defined according to the needs of the client.

### Trolleys

For hoist t	No. of wheels	No. of driving wheels	Min. radius of the curve	Amount of air l/sec	Speed m/min
0,25 - 2,0	4	2	1,5	25	9, 6, 12
3,0	4	2	2	25	6
6,0	4	2	2,5	25	6
9 / 10 / 12	4	2	2,5	50	8
15,0	4	2	3	50	6
20,0	4	2	3	50	4
25,0 x 4	4	2	3	50	4
25,0 x 8	8	4	Suora	100	6
35,0 x 8	8	4	Suora	100	4
50,0 x 8	8	4	Suora	100	4

**Note!** In order to operate properly, air compressed hoists, trolleys and winches need a high quality air compression network equipped with a moisture remover and lubrication system. Components required can be delivered with the product.

### Red Rooster winches

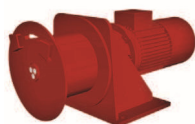

FD-series, 8 models  
Max. workloads  
800 - 5250 kg



SB-series for lifting, 14 models  
Max. workloads  
1200 - 20000 kg

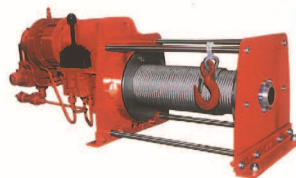

PFW-L-series for lifting, 6  
models Max. workloads  
500 - 3000 kg



LV-series, 6 models  
Max. workloads  
250 - 2000 kg

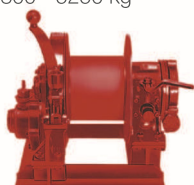

RRI-series, 4 models  
Max. workloads  
500 - 2000 kg

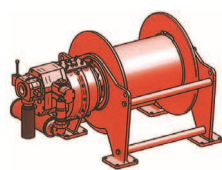

OAW offshore -series, 14 models  
Max. workloads  
1955 - 14980 kg

Ask for more information on  
the products from our sales!  
Each product is tailored  
individually to meet the needs  
of the client.

## PUSH TROLLEYS

- suitable for IPE- and T-beams
- sizes 500 - 5000 kg
- the hoist/lifter is attached directly to the trolley eye from a hook or with a shackle
- wheels are equipped with duration lubricated ball bearings
- equipped with break supports
- paint coated

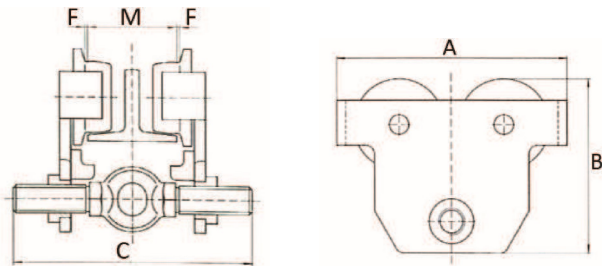

WLL kg	I/T-beam width mm	A mm	B mm	C mm	Min. radius of curve m	Weight kg	Product code
500	50-220	225	176,5	292	0,9	8,30	SIVA05ABT
1000	50-220	252	188	300	1,0	10,90	SIVA10ABT
1000	160-305	252	188	385	1,0	11,40	SIVA10LABT
2000	66-220	300	226	310	1,2	18,20	SIVA20ABT
2000	160-305	300	226	395	1,2	19,00	SIVA20LABT
3000	74-220	360	290	324	1,3	31,40	SIVA30ABT
3000	160-305	360	290	409	1,3	32,50	SIVA30LABT
5000	149-220	492	313	329	1,4	42,60	SIVA50ABT
5000	160-305	492	313	414	1,4	44,00	SIVA50LABT

## CHAIN TROLLEYS

- the trolley moves on the beam by pulling the hand chain
- standard length of a hand chain is approx. 3 m, allowing for mounting the trolley at about 4 m height
- also available with longer chain
- suitable for I- and T-beams
- sizes 1000 - 30000 kg
- the hoist/lifter is attached directly to the trolley eye from a hook or with a shackle
- wheels are equipped with duration lubricated ball bearings
- equipped with break supports
- paint coated

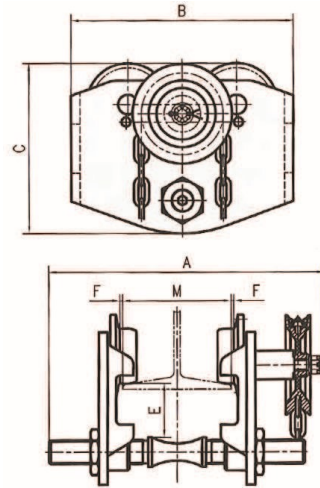

WLL kg	IPE-beam width M mm	A mm	B mm	C mm	E mm	Min. radius of curve m	Weight kg	Product code
1000	50-220	302.5	252	188	60	1,0	15,90	SIVA10ABTKS
2000	74-220	319.5	300	226	70	1,2	23,20	SIVA20ABTKS
3000	90-220	354	360	290	80	1,3	37,70	SIVA30ABTKS
5000	114-220	365	400	313	-	1,4	48,90	SIVA50ABTKS
10000	124-305	510	424	396	-	2,0	84,00	SIVA100LABT
20000	136-305	604	555	498	-	3,5	190,0	SIVA200LABT



## CHAIN LEVER HOISTS



- high quality hoist
- available also with overload protection
- standard lifting height 3 m
- also other lifting heights delivered quickly
- upper and lower hook with swivel
- equipped with RFID
- inspection points on the hook
- works also as a pulling hoist
- paint coated
- EN 13157

WLL kg	No. of chains	Chain mm	A mm	B mm	C mm	D mm	E mm	F mm	H mm	Weight with 3 m lift kg	Product code	Product code With overload protection
250	1	4 x 12	100	70	56	163	20	31	235	2,5	VTHA250	VTHA250Y
500	1	5 x 15	150	90	118	253	22	32	310	5,5	VTHA500	VTHA500Y
800	1	5,6 x 17	158	98	132	273	23	36	340	6,5	VTHA800	VTHA800Y
1600	1	7,1 x 21	185	111	145	378	29	43	400	10,2	VTHA1600	VTHA1600Y
3200	1	10 x 28	212	124	198	418	37	50	520	22,0	VTHA3200	VTHA3200Y
6300	2	10 x 28	212	124	230	418	43	53	640	34,0	VTHA6000	-
9000	3	10 x 28	212	124	338	418	44	67	730	45,0	VTHA9000	-

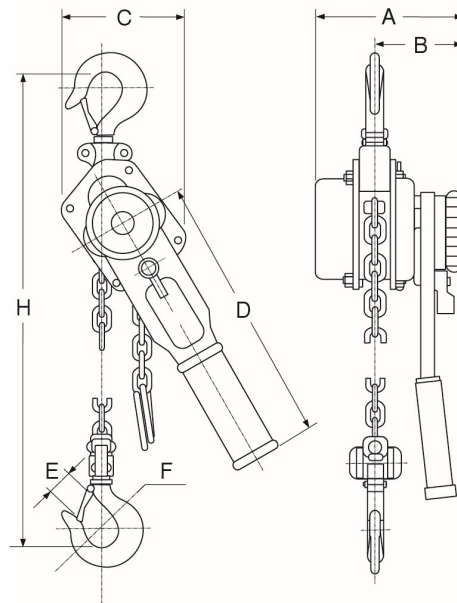

It is important to take care of the lubrication of the hoist chain. Correctly lubricated chain has much longer life span and it ensures safe, silent and trouble-free operation of the product.

Product code: KETSPRAY

## MINI CHAIN LEVER HOISTS

 NEW

- extremely small and lightweight hoists for i.a. mounting operations
- 250, 500 and 750 kg hoists are packed in a carrying bag which can be fixed on a belt
- standard lifting height 3 m
- also other lifting heights quickly delivered
- upper and lower hook with swivel
- works also as a pulling hoist
- paint coated

WLL	No. of chains	Chain	a	b	c	d	e	f	g	s	t	Weight with 3 m lift	Product code
kg		mm	mm	mm	mm	mm	mm	mm	mm	mm	mm	kg	
250	1	3	87	68	200	145	55,5	35,5	21	32	11	2,2	VTS250
500	1	4,3	100,5	81	250	160	62,5	42	24,5	34,5	12	3,6	VTS500
750	1	5	105	92	260	180	64	42	28,5	35,5	14	4,7	VTS750
1500	1	7,1	122	109	330	220	68,5	52	35	42,5	21,5	8,5	VTS1500



250 kg



500 kg



750 kg



1500 kg

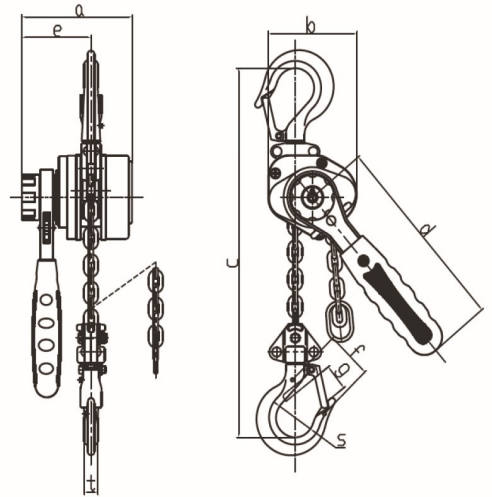

250, 500 and 750 kg hoists are packed in a carrying bag which can be fixed on a belt.



## HAND CHAIN HOISTS



- high quality hoist
- lower and upper hook with swivel
- maximum workload is achieved with fairly low hand power
- length of the hand chain is always the same as the lifting height
- equipped with RFID
- also other lifting heights quickly delivered
- paint coated
- EN 13157

WLL kg	Lifting height m	No. of chains	Chain mm	A mm	B mm	C mm	D mm	H mm	Weight kg	Product code	Product code
										Lifting height 3 m	Lifting height 6 m
250	3 / 6	1	4 x 12	108	106	20	30	260	6,0	KTHA250	KTHA2506
500	3 / 6	1	5 x 15	130	128	22	34	280	9,0	KTHA500	KTHA5006
1000	3 / 6	1	6,3 x 19	150	142	26	39	330	12,0	KTHA1000	KTHA10006
2000	3 / 6	1	8 x 24	185	175	35	49	385	20,0	KTHA2000	KTHA20006
3000	3 / 6	2	7,1 x 21	220	158	37	50	510	24,0	KTHA3000	KTHA30006
5000	3 / 6	2	9 x 27	255	183	43	60	615	37,0	KTHA5000	KTHA50006
10000	6	4	9 x 27	360	183	47	65	820	104,6	-	KTHA10000
20000	8	8	9 x 27	577	183	75	90	1060	200,0	-	KTHA20000 (8m)

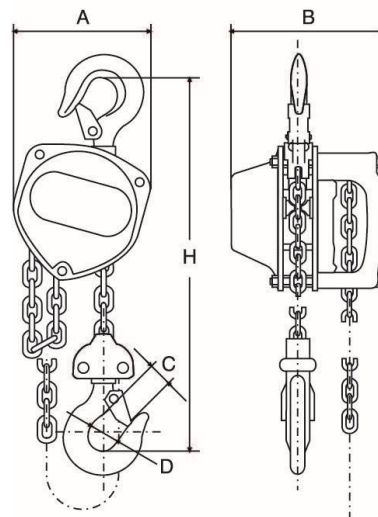

**ALSO AVAILABLE WITH OVERLOAD PROTECTION UP TO 5000 KG.** (Y-letter to the end of the product code)



It is important to take care of the lubrication of the hoist chain. Correctly lubricated chain has much longer life span and it ensures safe, silent and trouble-free operation of the product.

**Product code: KETSpray**

## LEVER HOIST POWERTEX

- Compact, lightweight construction.
- Durable all steel construction with powder coated finish and plated frame components.
- Safe, well covered automatic load reaction brake.
- European made COROLIM® protected load chain.
- Bottom hook with ball bearing.
- RFID equipped (chip) for easy service and inspection.
- QR code for on-site access to Multilanguage user manuals.
- User manuals in 14 languages included.
- Fulfills the Machinery Directive 2006/42/EC.
- Comply fully with the EN norms 13157 and 818-7.
- Testcertificate enclosed.

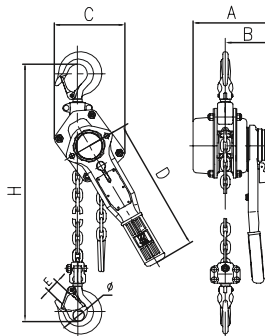
**POWERTEX**

Art No/1,5 m lift	Art No/3 m lift	Fall	Std. lift	Load chain Ø	Test load	A	B	C	D	E	H min	Weight*	
		tons	m		kg				mm			kg	
16.20PLH0025015	16.10PLH0025030	0,25	1	1,5	4 x 12	375	100	71	86	158	18 20	280	2,3
16.20PLH0050015	16.10PLH0050030	0,5	1	1,5	5 x 15	750	150	90	118	253	20 22	280	5,3
16.20PLH0100015	16.10PLH0100030	1	1	1,5	6 x 18	1.500	156	95	138	278	25 26	330	8,1
16.20PLH0150015	16.10PLH0150030	1,5	1	1,5	7,1 x 21	2.400	186	112	145	378	30 29	385	11,2
16.20PLH0300015	16.10PLH0300030	3	1	1,5	10 x 28	4.800	208	120	198	388	36 37	435	20,5

Also available with overload protection: Art No + OLP. (Not 250 kg) Without load chain: Art No = last digits 00, instead of 30 and 60. Also available in Black Line: Art No + BK\*Weight for hoist with 1,5 m lift.



## CHAIN BLOCK POWERTEX

- Compact, lightweight construction.
- Durable all steel construction with powder coated finish and plated frame components.
- Safe, well covered automatic load reaction brake.
- Sealed ball bearings on the chain wheel maximise efficiency and serviceability.
- European made COROLIM® protected load chain.
- Bottom hook with ball bearing.
- RFID equipped (chip) for easy service and inspection.
- QR code for on-site access to Multilanguage user manuals.
- User manuals in 14 languages included.
- Fulfills the Machinery Directive 2006/42/EC.
- Comply fully with the EN norms 13157 and 818-7.
- Testcertificate enclosed.

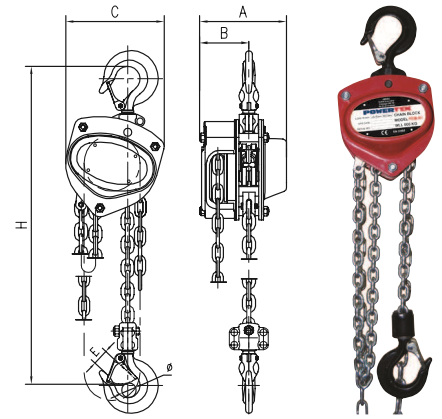

**POWERTEX**

Art No/3 m lift	Art No/6 m lift	WLL tons	Std. lift m	Load chain Ø	Test load kg	A	B	C	D	E	H	Weight kg	
						mm							
16.10PCB0025030	16.10PCB0025060	0,25	1	3,0	4 x 12	375	106	68	108	18	20	280	6,4
16.10PCB0050030	16.10PCB0050060	0,5	1	3,0	5 x 15	750	128	75	130	20	22	280	8,9
16.10PCB0100030	16.10PCB0100060	1	1	3,0	6,3 x 19,1	1.500	142	76	150	25	26	330	12,0
16.10PCB0200030	16.10PCB0200060	2	1	3,0	8 x 24	3.000	175	88	185	33	35	385	19,5
16.10PCB0300030	16.10PCB0300060	3	1	3,0	10 x 30	4.500	195	95	226	36	37	435	29,4
16.10PCB0500030	16.10PCB0500060	5	2	3,0	9 x 27	7.500	183	90	255	43	43	615	36,3
16.10PCB1000030	16.10PCB1000060	10	3	3,0	10 x 30 *	15.000	195	95	355	44	47	810	64,1

\* G100 chain. Also available with overload protection: Art No + OLP. (Not 250 and 10.000 kg) Without load chain: Art No = last digits 00, instead of 30 and 60.  
Also available in Black Line: Art No + BK

## CHAINBAG

**General:** Chainbag that fits on most models of chain hoists because of the mounting.

**Material:** Pvc-coated fabric.

**Colour:** Black.

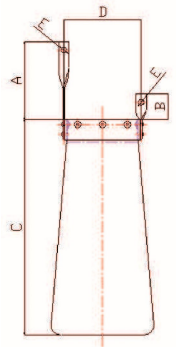

Chainblock with chainbag and warning tag mounted



Chainblock with chainbag mounted



Mounting bolts

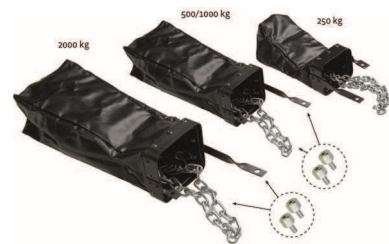

Art No	WLL tons	A	B	C/12 m/bag mm	D	E	F	Capacity m
16.10PCB100300	0,25	98	38	200	93	Ø 6.5	-	12
16.10PCB100301	0,5/1	119	39	330	118	Ø 8.5	M8	12
16.10PCB100302	2	139	59	450	138	Ø 10.5	M10	12

## CHAIN BLOCK POWERTEX BLACKLINE

**General:** Chain block designed especially for theater and show business. To avoid reflection all parts are of non-reflecting color. POWERTEX chain block has a compact and low build design with low dead weight. Hook with safety latch. Can be delivered with POWERTEX push- or geared trolley, or POWERTEX beam clamp.

**Material:** Chain and hook, toughened steel grade 8.

**Marking:** WLL, code and CE marking.

**Safety factor:** 4:1.

**Finish:** Black painted.



**POWERTEX**

Art No	Code	WLL	Liftheight	Bridge-height	Liftchain Ø	No offalls	Hook-width	Weight
		tons	m	mm	mm	pcs	mm	kg
16.10PCH0050060BK	PCH-050B	0,5	6	350	5	1	23	13

## MANUAL CHAIN HOIST

**General:** This chain hoist gives you safe operation in potentially explosive atmosphere. It is protected against explosive gases, vapors and dust. Hereby KITO ensures the qualified use of the KITO CB ATEX chain hoist series conforming to the ATEX Directive.

Available for use in T4 temperature environments.

**Marking:** Type plate with WLL, CE-marking and serial number.

**Safety factor:** 4:1.

**Finish:** Painted.



### Options:

- Different suspension types include: include top hook and KITO Universal Trolleys TS model ATEX version (plain or hand geared trolley configurations) for improved load control.
- Overload Protection Device (OLL): the unique slip clutch mechanism protects the hoist from damage in the event of an excessive overload without increasing the size of the unit.
- Special capacities are available on request.

**KITO**

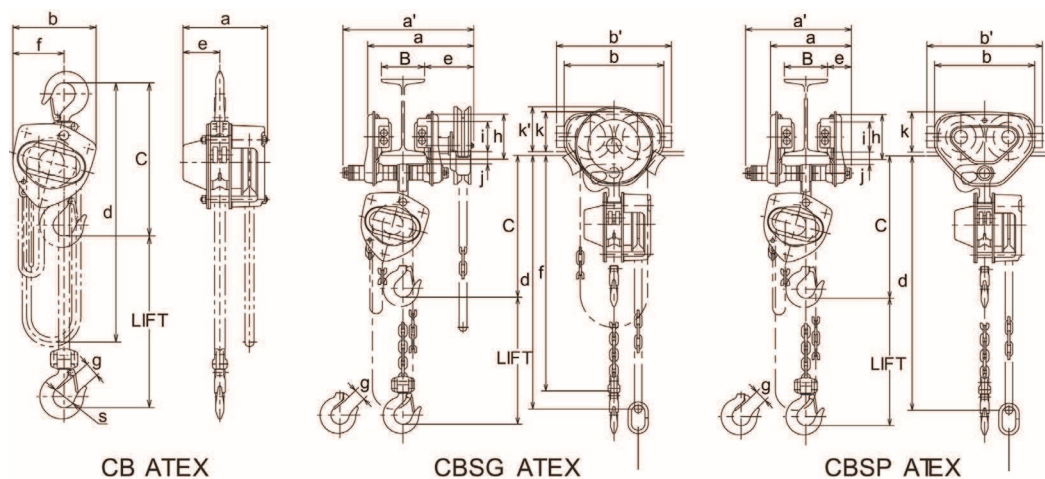

Art No	Type	Std. lift	Chain pull to lift full load	Load chain Ø	Head-room C	a	b	d	e	f	g	s			
						mm	mm	mm	mm	mm	mm	mm	mm	kg	
16.10CB005ESH030030	CB005 ATEX	0,5	2,5	29	6,3 x 19	1	295	162	161	2500	71	99	39	42,5	11,5



## PULLING AND LIFTING HOIST, TIRFOR® TU

**General:** Portable hoist to lift and pull loads, for utilisation in numerous configurations with long cable lengths.

- Low weight - quick installation
- No limitation in terms of cable length
- Manageable, light-weight, robust, powerful
- Increase load capacity with deflection sheaves
- Overload protection
- Precise load placement within millimetres

**Marking:** Serial number and CE-marking.

**Safety factor:** Tackle 5:1.

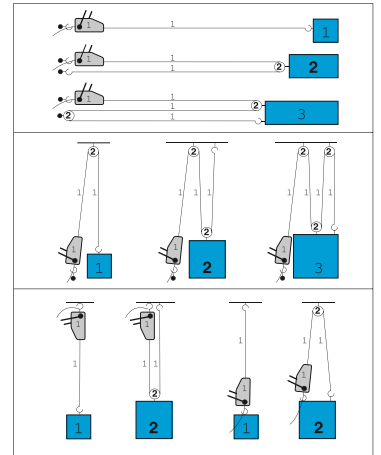
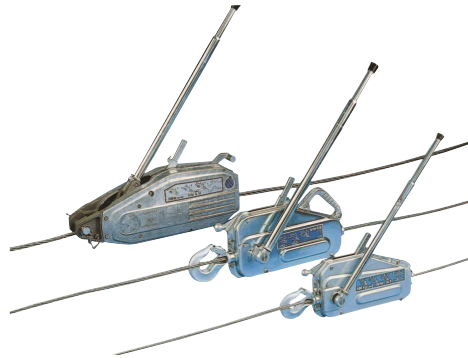

Art No	Code	WLL	Wire rope weight 20m	Dim. of the machine	Handle open/closed	Special TIRFOR wire rope Ø	Wire rope breaking strain	Weight machine
		tons	kg				kg	
	TU-8	0,8	6,1	527 x 265 x 108	770 - 510	8,3	4.000	8,4
	TU-16	1,6	13,1	660 x 330 x 140	1190 - 680	11,5	8.000	18

Approved only with original Tirfor® wire rope.

## PULLING AND LIFTING HOIST, TIRFOR® T

**General:** Portable hoist to lift and pull loads, for utilisation in numerous configurations with long cable lengths.

- Low weight - quick installation
- No limitation in terms of cable length
- Manageable, light-weight, robust, powerful
- Increase load capacity with deflection sheave:
- Overload protection
- Precise load placement within millimetres

**Marking:** Serial number and CE-marking.

**Safety factor:** Tackle 5:1.

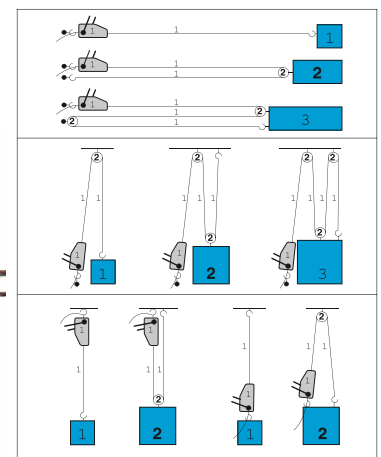

Art No	Code	WLL	Wire rope weight 20m	Dim. of the machine	Handle open/closed	Special TIRFOR wire rope Ø	Wire rope breaking strain	Weight machine
		tons	kg				kg	
16.25018109	T-508D	0,8	6,1	420 x 250 x 59	690 - 400	8,3	4.000	6,6
16.25018119	T-516D	1,6	13,1	530 x 315 x 127	1150 - 650	11,5	8.000	13,5
16.25018129	T-532D	3,2	26,6	620 x 355 x 130	1150 - 650	16,3	16.000	24,0

Approved only with original Tirfor® wire rope.

## PULLING HOIST, HYDRAULIC TIRFOR® TU 16 H

**General:** Hydraulic Tirfor™ machines are portable motorised hoists used with maxiflex wire rope. They can be used to lift, pull and position loads over great distances depending on the wire rope length. They are suitable for use in numerous configurations and are the ideal solution for use in professional applications; they are operated by a hydraulic cylinder powered by either an electrical power pack or a petrol motor power pack.

**Option:** the load capacity of the Tirfor® system can be increased by using sheave blocks.

- Low weight-quick installation
- No limitation in terms of wire rope length
- Easy to use, light-weight, robust, powerful, increased wear-resistance
- Increase load capacity with sheave blocks
- Overload protection
- Precise load positioning within millimetres

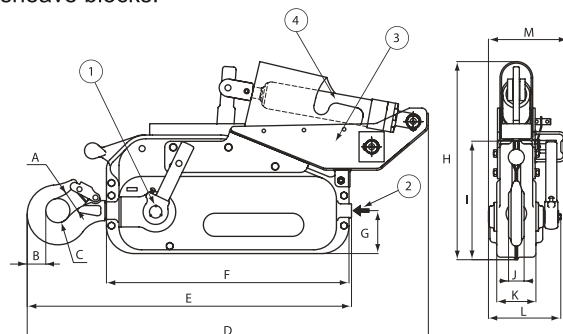
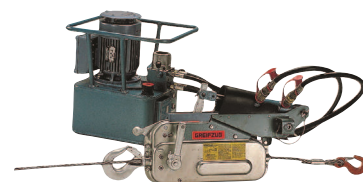

## PULLING HOIST, HYDRAULIC TIRFOR® TU 32

**General:** Hydraulic Tirfor™ machines are portable motorised hoists used with maxiflex wire rope. They can be used to lift, pull and position loads over great distances depending on the wire rope length. They are suitable for use in numerous configurations and are the ideal solution for use in professional applications; they are operated by a hydraulic cylinder powered by either an electrical power pack or a petrol motor power pack.

**Option:** the load capacity of the Tirfor® system can be increased by using sheave blocks.

- Low weight-quick installation
- No limitation in terms of wire rope length
- Easy to use, light-weight, robust, powerful, increased wear-resistance
- Increase load capacity with sheave blocks
- Overload protection
- Precise load positioning within millimetres

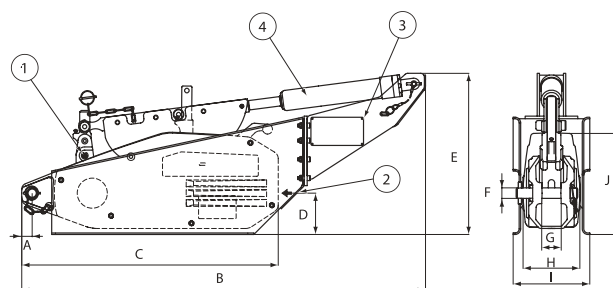
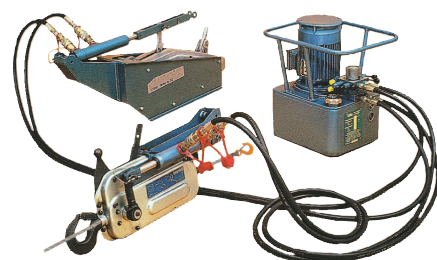

## ELECTRIC CHAIN HOIST KITO EQ SERIES

**General:** The KITO EQ electric chain hoist is a small and powerful chain hoist with hanging suspension, aluminium die-cast body, heavy duty fan-cooled motor and a plastic chain container.

High productivity feature: 130% speed at less than 30% WLL.

**Standard configuration:**

- Frequency inverter
- 380 - 460 V/3 phase
- Overload protection via frequency inverter
- Counter hour meter
- Upper - lower limit switch
- Pull-rotor motor brake
- Nickel plated load chain class grade 80 (DAT) in accordance with Norm EN 818-7
- Plastic chain container
- Ergonomic push button control
- Control voltage 24 V DC
- Aluminium die-cast body small, light, rugged
- High duty rating FEM 3m / ISO M6 rating through 500 kg

**Options:**

- Plain and geared trolley
- Motorized trolley (inverter controlled - dual speed)
- Top hook



With electrical gear



**Note:** Maximum lift with chain bag is (125kg - 500kg) 15m, (1t) 6m.

**KITO**

Art No	Code	Std. lift	Traversing motor		Lifting speed m/min.		Load			Entire			
			Output kW	Rating% ED	High (light load) 0-30 % WLL	High 30-100 % WLL	chain Ø mm	falls	FEM	kg			
		0,125	6	0,5	40 / 20	22,1	17,0		1	3m	395	417	30
		0,25	6	0,5	40 / 20	13,0	10,0		1	3m	395	417	30

The last two digits in the article number indicates the lifting height.

Type	Traversing motor		Traversing speed* (m/min)	Flange width B (mm)		Min. radius curve (mm)		
	Output (kW)	Rating (%ED)		Standard	Option			
EQM1001IS-IS	0,4	27/13	Standard	24	4	58 to 163	164 to 305	800
EQM1003IS-IS	0,4	27/13	Standard	24	4	58 to 163	164 to 305	800

\* Adjustable traversing speed 24/2,4

## Top Hook for Kito EQ

**General:** Top hook for Kito electric chain hoist in two sizes: one for the EQ hoists with 125 kg, 250 kg and 500 kg load capacity. One suits only to EQ hoist with 1.000 kg load capacity.

**Finish:** Painted.



**KITO**

Art No	Description	For hoist
13.05KITEQ1CI1013	Top hook	125 kg - 500 kg



## ELECTRIC CHAIN HOIST KITO ED

**General:** The KITO ED electric chain hoist is compact, light-weight, reliable and weather- and corrosion-resistant. It has an aluminum gearbox, high performance mechanical brake, adjustable speed built-in potentiometer and a maximal speed of 20,1 m/min. The hook suspension type is offered with single or dual lifting speed. The cylinder control type (EDC) is offered with dual lifting speed.

**Marking:** Type plate with WLL, CE-marking and serial number.

**Finish:** Nickel plated load chain grade 80 (DAT) in accordance with EN 818-7.

### Options:

- Plain trolley
- Geared trolley
- Canvas chain bucket up to 70 m
- Steel chain bucket
- Radio remote control

**Standard:** EN 818-7.

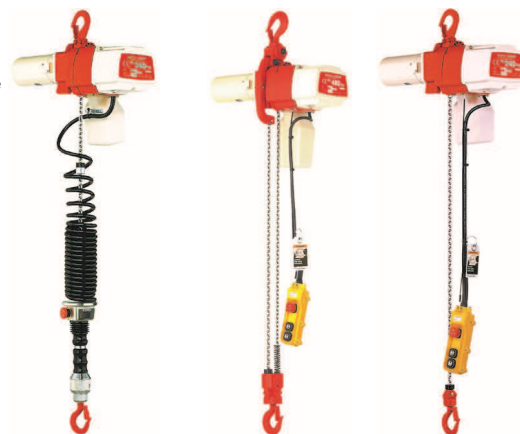

EDC

ED double speed

ED single speed

## KITO

Type	WLL tons	Class FEM	Lifting speed m/min	Duty rating % ED	Chain falls	Headroom mm	Weight kg
ED06S	0,060	1Am	20.1	30	1	315	11,5
ED10S	0,100	1Am	12.5	30	1	315	11,5
ED16S	0,160	1Am	19.2	30	1	330	15,5
ED18S	0,180	1Am	7.7	20	1	315	11,5

Standard lift 3 m

Type	WLL tons	Class FEM	Lifting speed m/min	Duty rating % ED	Chain falls	Headroom mm	Weight kg
ED06ST	0,060	1Am	20.1/4.0	30	1	315	12
ED10ST	0,100	1Am	12.5/3.0	30	1	315	12
ED16ST	0,160	1Am	19.2/4.0	30	1	330	16
ED18ST	0,180	1Am	7.7/3.0	20	1	315	12

Standard lift 3 m

Type	WLL tons	Class FEM	Lifting speed m/min	Duty rating % ED	Chain falls	Head room mm	Weight kg
EDC06SD	0,060	1Am	20,1/4,0	30	1	945	14,5
EDC10SD	0,100	1Am	12,5/3,0	30	1	945	14,5
EDC16SD	0,160	1Am	19,2/4,0	30	1	960	18,5

Standard lift 1,8 m

## ELECTRIC CHAIN HOIST KITO ER2 SINGLE

**General:** The KITO ER2 Electric Chain Hoists are durable, safe and easy to use hoists. It has a top hook or overhead mounting suspension, aluminium die-cast body, electromagnetic brake and a canvas chain container. It lifts from 125 kg up to 5 tons.

### Standard configuration:

- 400 V/50 Hz
- Contactor control for single speed
- CH-Meter: operating hours /number of starts
- Ergonomic push button control
- Upper-lower limit switch
- Nickel-plated load chain class grade 80 (DAT) in accordance with Norm EN 818-7
- Thermal protector
- Carbon friction clutch

### Options:

- 500 V/Contactor control
- 230 V/50 Hz/60 Hz, 3 phase
- Rubber bumpers for motorized trolleys
- Additional mechanical brake
- Electrical overload limiter
- Acoustic overload signal
- Radio remote control
- Variable speed control
- Level limit switch
- Steel chain container
- Trolley versions: motorized, geared and plain



**Note:** Can also be delivered with infinitely variable speed control, programmable level limits and cylinder control.



ER2 cylinder control

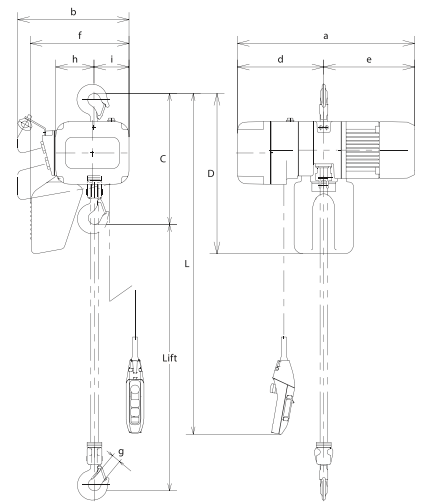

**KITO**

## Technical specifications

WLL	Product	Lifting motor		Lifting speed* (m/min)	Load chain Ø	Chain Falls	Class	Test load	Net weight	Additional weight per 1 m lift
tons	code	Output (kW)	Rating(%ED)	50Hz	mm		ISO/FEM	kg	kg	kg
0,125	ER2-001H	0,56	60	14,1	4,3 x 12	1	M5/2m	156	27	0,42
0,25	ER2-003S	0,56	60	9,1	4,3 x 12	1	M5/2m	313	27	0,42
0,25	ER2-003H	0,56	60	13,4	6,0 x 16,8	1	M5/2m	313	37	0,81
0,5	ER2-005L	0,9	60	3,8	6,0 x 16,8	1	M5/2m	625	33	0,81
0,5	ER2-005S	0,56	60	7,3	6,0 x 16,8	1	M5/2m	625	37	0,81
1	ER2-010L	0,9	60	3,5	7,7 x 21,5	1	M5/2m	1250	47	1,33
1	ER2-010S	0,9	60	7,1	7,7 x 21,5	1	M5/2m	1250	54	1,33
1,6	ER2-016S	1,8	60	4,5	10,2 x 28,5	1	M5/2m	2000	72	2,3

\* Note: The high speed is present to the maximum speed at the KITO factory in Japan. The low speed can be increased or respectively reduced.

WLL	Produkt	Min. headroom C	D	a	b	d	e	f	g	h	i
tons	code	mm	mm	mm	mm	mm	mm	mm	mm	mm	mm
0,125	ER2-001H	350	430	478	321	219	259	260	27	99	93
0,250	ER2-003S	350	430	478	321	219	259	260	27	99	93
0,250	ER2-003H	370	490	510	348	242	268	283	27	113	106
0,500	ER2-005L	370	490	513	348	242	271	283	27	113	106
0,500	ER2-005S	370	490	510	348	242	268	283	27	113	106
1	ER2-010L	430	550	589	376	291	298	335	31	129	118
1	ER2-010S	430	550	598	376	291	307	335	31	129	118
1,6	ER2-016S	510	630	646	427	308	338	384,5	34	160,5	137,5
2	ER2-020L	575	630	646	427	308	338	384,5	39	160,5	137,5
2	ER2-020S	590	630	703	427	347	356	384,5	39	160,5	137,5



# ELECTRIC CHAIN HOIST KITO ER2 DUAL SPEED SERIES

## Electric chain hoist with hook suspension

**General:** The KITO ER2 Electric Chain Hoists are durable, safe and easy to use hoists. It has a top hook or overhead mounting suspension, aluminium die-cast body, electromagnetic brake and a canvas chain container. It lifts from 125 kg up to 5 tons.

**Standard configuration:**

- 400 V/50 Hz
- Frequency inverter for 2 lifting speeds
- CH-Meter: operating hours/number of starts
- Ergonomic push button control
- Upper-lower limit switch
- Nickel-plated load chain class grade 80 (DAT) in accordance with Norm EN 818-7
- Thermal protector
- Carbon friction clutch

**Options:**

- 500 V/Contactor control
- 230 V/50 Hz/60 Hz, 3 phase
- Rubber bumpers for motorized trolleys
- Additional mechanical brake
- Electrical overload limiter
- Acoustic overload signal
- Radio remote control
- Variable speed control
- Level limit switch
- Steel chain container
- Trolley versions: motorized, geared and plain



**Note:** Can also be delivered with infinitely variable speed control, programmable level limits and cylinder control.



ER2 cylinder control

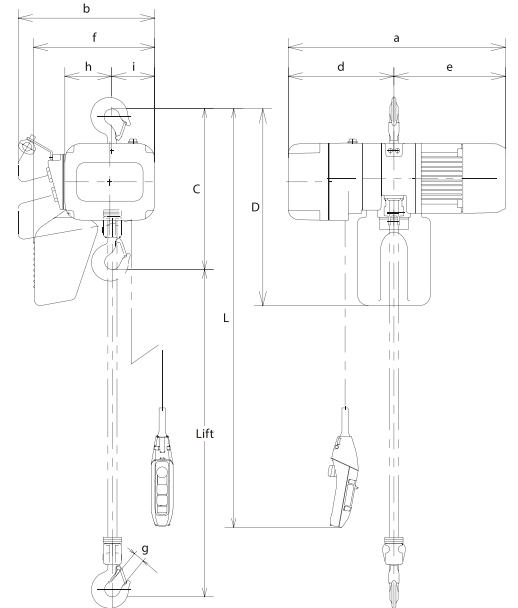

**KITO**

**Option:**

- Push trolley
- Electric trolley
- Geared trolley



Push trolley



Electric trolley



Geared trolley

## Technical specifications

WLL tons	Product code	Lifting motor		Lifting speed* (m/min)		Load chain ∅ mm	Chain falls	Class ISO/ FEM	Test load kg	Net weight kg	Additional weight pr. 1 m lift kg	
		Out- put (kW)	Rat- ing	50Hz high	50Hz low							
0,125	ER2-001IH	0,56	40/20	Preset Adjustable	16,6	2,81,4	4,3 x 12	1	M6/3m	156	27	0,42
0,25	ER2-003IS	0,56	40/20	Preset Adjustable	10,8	1,80,9	4,3 x 12	1	M6/3m	313	27	0,42
0,25	ER2-003IH	0,9	40/20	Preset Adjustable	15,7	2,61,3	6,0 x 16,8	1	M6/3m	313	36	0,81
0,5	ER2-005IL	0,56	40/20	Preset Adjustable	4,5	0,80,4	6,0 x 16,8	1	M6/3m	625	32	0,81
0,5	ER2-005IS	0,9	40/20	Preset Adjustable	8,5	1,40,7	6,0 x 16,8	1	M6/3m	625	36	0,81
1	ER2-010IL	0,9	40/20	Preset Adjustable	4,2	0,70,3	7,7 x 21,5	1	M5/2m	1250	45	1,33

\* Note: The high speed is present to the maximum speed at the KITO factory in Japan. The low speed can be increased or respectively reduced.

WLL tons	Product code	Min. headroom C mm	D mm	a mm	b mm	d mm	e mm	f mm	g mm	h mm	i mm
0,125	ER2-001IH	350	430	535	345	276	259	284	27	99	117
0,250	ER2-003IS	350	430	535	345	276	259	284	27	99	117
0,250	ER2-003IH	370	490	568	348	300	268	283	27	113	106
0,5	ER2-005IL	370	490	571	348	300	271	283	27	113	106
0,5	ER2-005IS	370	490	568	348	300	268	283	27	113	106
1	ER2-010IL	430	550	614	376	316	298	335	31	129	118
1	ER2-010IS	430	550	623	376	316	307	335	31	129	118
1,6	ER2-016IS	510	630	710	427	372	338	384,5	34	160,5	137,5
2	ER2-020IL	575	630	710	427	372	338	384,5	39	160,5	137,5
2	ER2-020IS	590	630	767	427	411	356	384,5	39	160,5	137,5

# ELECTRIC CHAIN HOIST KITO ER2 LARGE CAPACITY SINGLE SPEED SERIES

**General:** The KITO ER2 Electric Chain Hoists are durable, safe and easy to use hoists. It has a top hook or overhead mounting suspension, aluminium die-cast body, electro-magnetic brake and a canvas chain container. It lifts from 10 tons up to 20 tons.

**Standard configuration:**

- 400 V/50 Hz
- Contactor control for single speed
- CH-Meter: operating hours/number of starts
- Ergonomic push button control
- Upper-lower limit switch
- Nickel-plated load chain class grade 80 (DAT) in accordance with Norm EN 818-7
- Thermal protector
- Carbon friction clutch

**Options:**

- 500 V/Contactor control
- 230 V/50 Hz/60 Hz, 3 phase
- Rubber bumpers for motorized trolleys
- Additional mechanical brake
- Electrical overload limiter
- Acoustic overload signal
- Radio remote control
- Variable speed control
- Level limit switch
- Steel chain container
- Trolley versions: motorized, geared and plain

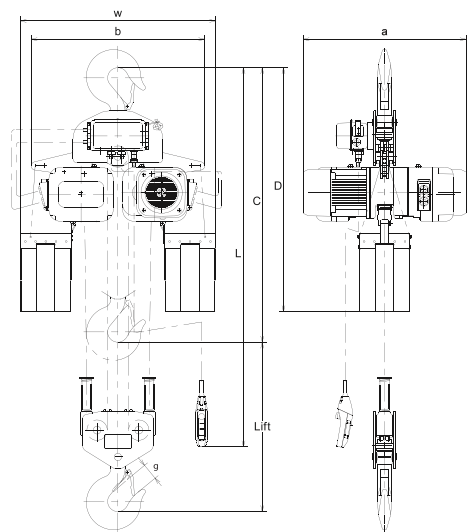

**KITO**

WLL tons	Product code	Min. headroom C mm	D mm	a mm	b mm	w mm	g mm
10	ER2-100S	1370	1210	798	849	956	80
15	ER2-150S	1595	1520	798	1022	1129	86



## ELECTRIC CHAIN HOIST KITO ER2 LARGE CAPACITY DUAL SPEED SERIES

**General:** The KITO ER2 Electric Chain Hoists are durable, safe and easy to use hoists. It has a top hook or overhead mounting suspension, aluminium die-cast body, electromagnetic brake and a canvas chain container. It lifts from 10 tons up to 20 tons.

### Standard configuration:

- 400 V/50 Hz
- Frequency inverter for 2 lifting speeds
- CH-Meter: operating hours/number of starts
- Ergonomic push button control
- Upper-lower limit switch
- Nickel-plated load chain class grade 80 (DAT) in accordance with Norm EN 818-7
- Thermal protector
- Carbon friction clutch

### Options:

- 500 V/Contactor control
- 230 V/50 Hz/60 Hz, 3 phase
- Rubber bumpers for motorized trolleys
- Additional mechanical brake
- Electrical overload limiter
- Acoustic overload signal
- Radio remote control
- Variable speed control
- Level limit switch
- Steel chain container
- Trolley versions: motorized, geared and plain

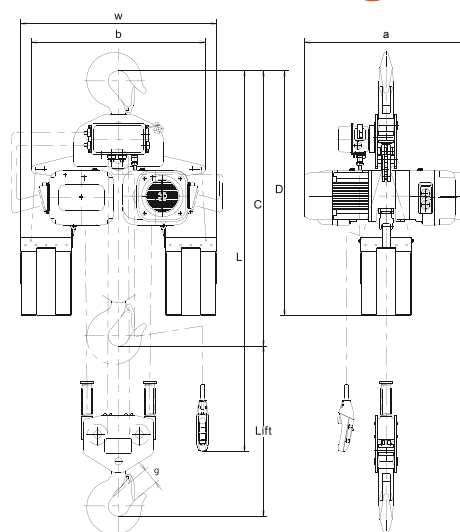

**KITO**

WLL tons	Product code	Lifting motor		Lifting speed*(m/min)	Load chain (mm) x falls	Chain falls	Class ISO/ FEM	Test load tons	Net weight kg	Additional weigh per 1 m lift kg
		Output (kW)	Rating (%ED)							
10	ER2-100IS	3,5x2	40/20	Preset Adjusta- ble 3,3	11,2 x 31,3	4	M4/1Am	12,5	303	11,0

\* Note: The high speed is present to the maximum speed at the KITO factory in Japan. The low speed can be increased or respectively reduced.

WLL tons	Product code	Min. headroom C mm	D mm	a mm	b mm	w mm	g mm
10	ER2-100IS	1370	1210	798	849	956	80
15	ER2-150IS	1595	1520	798	1022	1129	86

## ELECTRIC CHAIN HOIST KITO FER2

**General:** The electric chain hoist engineered for the food industry. Food grade lubricants used on the load chain and in the gearbox are NFS H1 compliant for safe use in any facility where incidental contact with products is a concern.

It lifts from 500 kg up to 2 tons.

**Working temperature:** -20°C up to +40°C.

### Standard configurations:

- 400 V/50 Hz/3P
- Standard lifting height 3 m
- Electromagnetic brake: improved performance and safety
- Robust Aluminium die-cast body protects the frequency inverter against external influences
- White epoxy bottom hook
- Stainless steel hook latch
- Totally enclosed, fan-cooled electric motor
- Low-maintenance and easy-operation frequency inverter for 2 lifting speeds for an exact positioning of the load
- Contactor control for single speed
- Carbon friction clutch: protects the chain hoist in the case of an overload against damages and offers the user a higher degree of safety
- Canvas chain container as standard
- Upgraded annealing process of the nickel-plated load chain (class DAT in accordance with standard EN 818-7) with high strength (800 N/mm<sup>2</sup>) ensures ultimate resistance and durability

### Options:

- Corrosion resistant hook kit - stainless steel load hook, stainless steel rubber cushion (0.5t & 1t), nickel plated stopper (0.5t & 1t), stainless steel chain spring & limiting plate (2t)
- Corrosion resistant trolley kit - stainless steel trolley wheels, stainless steel guide rollers, nickel plated suspender, nickel plated suspension shaft
- Stainless steel, plastic or canvas chain container
- Pendant cover

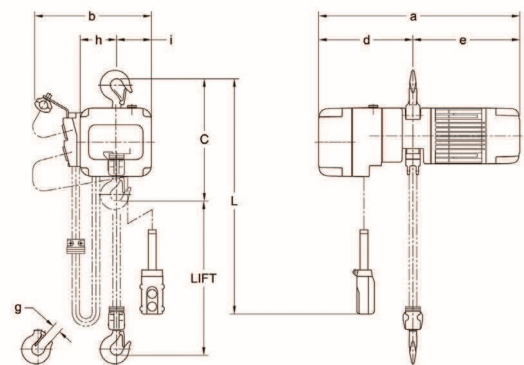

**KITO**

WLL tons	Product code	Lifting speed m/min	Hoist motor H.P.	Bottom hook headroom mm		Rated current (amp)			Load chain falls	Weight kg
				Standard	Stainless steel	220V	440V	575V		
0,5		4,6	0,75	370	452	3,4	1,7	1,4	1	33

tons	Product code	C	D	a	b	d	e	f	g	h	i
mm											
0,5	FER2005L	370	490	513	348	242	271	283	27	113	106
1	FER2010L	430	550	589	376	291	298	335	31	129	118

## TROLLEY

**General:** Low-built block trolley for hanging e.g. chain blocks and wire hoists. The trolley can be supplied with a load of 0.5 tons up to 5 tons. The trolley has corner protection which prevents the trolley from detaching from the beam and ball bearing wheels. It is easily adjustable by the left- and right-handed carrier bracket and fits most brands of hoists.

**Marking:** WLL, name plate and CE.

**Finish:** Black painted.

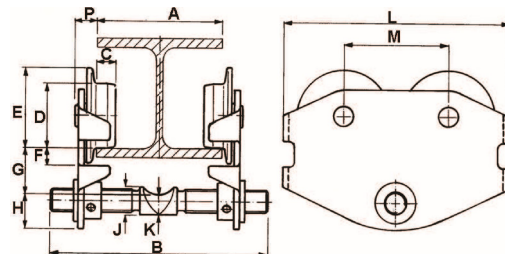

 available

Art No	WLL	Type	A min-max	B	C	ØD	E	F	G	H	Ø J	Ø K	L	M	P	Min curve r	Weight
	tons															m	kg
16.0520123A	0,5	20123A	46-160	208	62	77					25	19	216	100		1,0	6,0
16.0520124A	0,5	20124A	161-280	208	62	77					25	19	216	100		1,0	6,4
16.0520143A	1	20143A	50-160	212	70	85					32	24	264	130		1,25	9,4
16.0520144A	1	20144A	161-280	212	70	85					32	24	264	130		1,25	10,7
16.0520163A	2	20163A	64-180	248	100	118					40	32	345	165		1,80	19,0
16.0520164A	2	20164A	181-300	248	100	118					40	32	345	165		1,80	21,0
16.0520173A	3	20173A	74-180	262	114	137					46	35	384	180		2,20	31,5

## TROLLEY 21

**General:** Low-built block trolley for hanging e.g. chain blocks and wire hoists. The trolley can be supplied with a load of 0.5 tons up to 5 tons. The trolley has corner protection which prevents the trolley from detaching from the beam and ball bearing wheels. It is easily adjustable by the left- and right-handed carrier bracket and fits most brands of hoists.

**Marking:** WLL, name plate and CE.

**Finish:** Black painted.

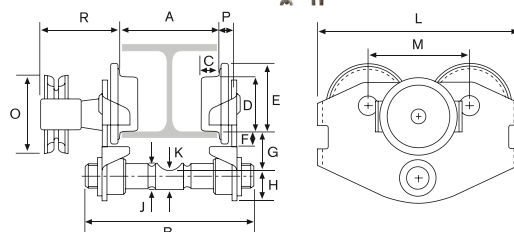

 available

Art No	Type	A min-max	B	C	Ø D	E	F	G	H	Ø J	Ø K	L	M	Ø O	P	R	Min curve r	Weight
	ton									mm							m	kg
16.0521123A	0,5	21123A	50-160	212	70	88				32	19						1,25	14,3
16.05211245A	0,5	21124A	161-280		70	88				32	19						1,25	15,5
16.0521143A	1	21143A	50-160	212	70	88				32	24						1,25	14,3
16.0521144A	1		161-280		70	88				32	24						1,25	15,5
16.0521163A	2	21163A	64-180	248						40	32						1,80	25,3
16.0521164A	2	21164A	181-300							40	32						1,80	27,4
16.0521173A	3	21173A	74-180	262						46	35						2,20	38,2



## PLAIN TROLLEY TSP KITO

**General:** Plain trolley with capacity from 0,125 tons up to 5 tons.  
The standard trolley includes rubber bumper, safety lug and suspender.  
**Material:** Pressed steel plate.



Plain Trolley TSP 5t



Plain Trolley TSP 0,125-3t

### KITO

Art No Standard	Art No W30	Max. load ton	I beam width range standard	I beam width range W30
16.05TSP001SC	16.05TSP0012C	0,125	50-163	164-305
16.05TSP003SC	16.05TSP0032C	0,25	50-163	164-305
16.05TSP005SC	16.05TSP0052C	0,5	50-163	164-305
16.05TSP010SC	16.05TSP0102C	1	58-163	164-305
16.05TSP015SC	16.05TSP0152C	1,5	82-204	205-305
16.05TSP020SC	16.05TSP0202C	2	82-204	205-305
16.05TSP025SC	16.05TSP0252C	2,5	82-204	205-305

## GEARED TROLLEY TSG KITO

**General:** Geared trolley with capacity from 0,125 tons up to 5 tons.  
The standard trolley includes rubber bumper, safety lug and suspender.  
**Material:** Pressed steel plate.



Geared Trolley TSG 5t



Geared Trolley TSG  
0,125-3t

### KITO

Art No Standard	Art No W30	Max. load ton	I beam width range Standard	I beam width range W30	Kæde længde m
16.05TSG001SC030	16.05TSG0012C030	0,125	58-163	164-305	3.0
16.05TSG002SC030	16.05TSG0032C030	0,25	58-163	164-305	3.0
16.05TSG005SC030	16.05TSG0052C030	0,5	58-163	164-305	3.0
16.05TSG010SC030	16.05TSG0102C030	1	58-163	164-305	3.0
16.05TSG015SC030	16.05TSG0152C030	1,5	82-204	205-305	3.0
16.05TSG020SC030	16.05TSG0202C030	2	82-204	205-305	3.0
16.05TSG025SC030	16.05TSG0252C030	2,5	82-204	205-305	3.0
16.05TSG030SC030	16.05TSG0302C030	3	82-204	205-305	3.0
16.05TSG050SC030	16.05TSG0502C030	5	100-204	205-305	3.5
16.05TSG075SC030	16.05TSG0752C030	7,5	150-220	221-305	3.5
16.05TSG100SC030	16.05TSG1002C030	10	150-220	221-305	4.0
16.05TSG150SC030	16.05TSG1502C030	15	150-220	221-305	4.5
16.05TSG200SC030	16.05TSG2002C030	20	150-220	221-305	4.5
16.05TSG300SC030	16.05TSG3002C030	30	190	191-305	4.5

## BEAM CLAMP POWERTEX TYPE

**Design:** POWERTEX beam clamp is adjustable for different beam types. Designed to provide quick rigging and hoisting points for a great variety of applications. Low headroom design. Supplied with grey label for adhering over white nameplate for use in the entertainment industry.

**Proof load:** 1,5 x WLL.

**Safety factor:** 4:1.

**Marking:** WLL, and CE-marking.

**Finish:** Black painted.

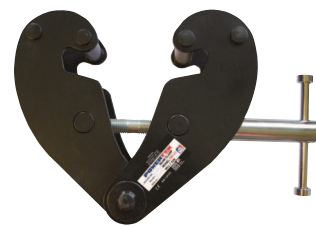

**POWERTEX**

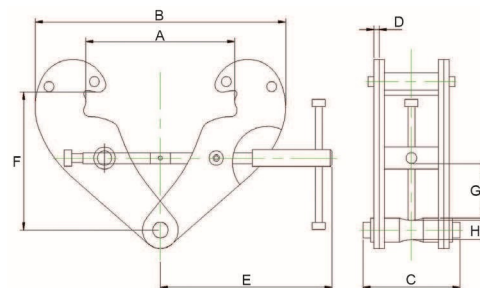

Art No	Code	WLL tons	I beam width range mm	A	B	B	C	D	E	H	F	F	G	kg.
				max.	min.	max.		mm	min.	max.	min.			
	1t PBC	1	80-240	270	183	370	94	4	198	20	100	154	22	3,5
	2t PBC	2	80-240	270	183	370	102	6	198	20	100	154	22	4,5