

SAFETY INSTRUCTIONS

and information on the use and maintenance of steel wire rope

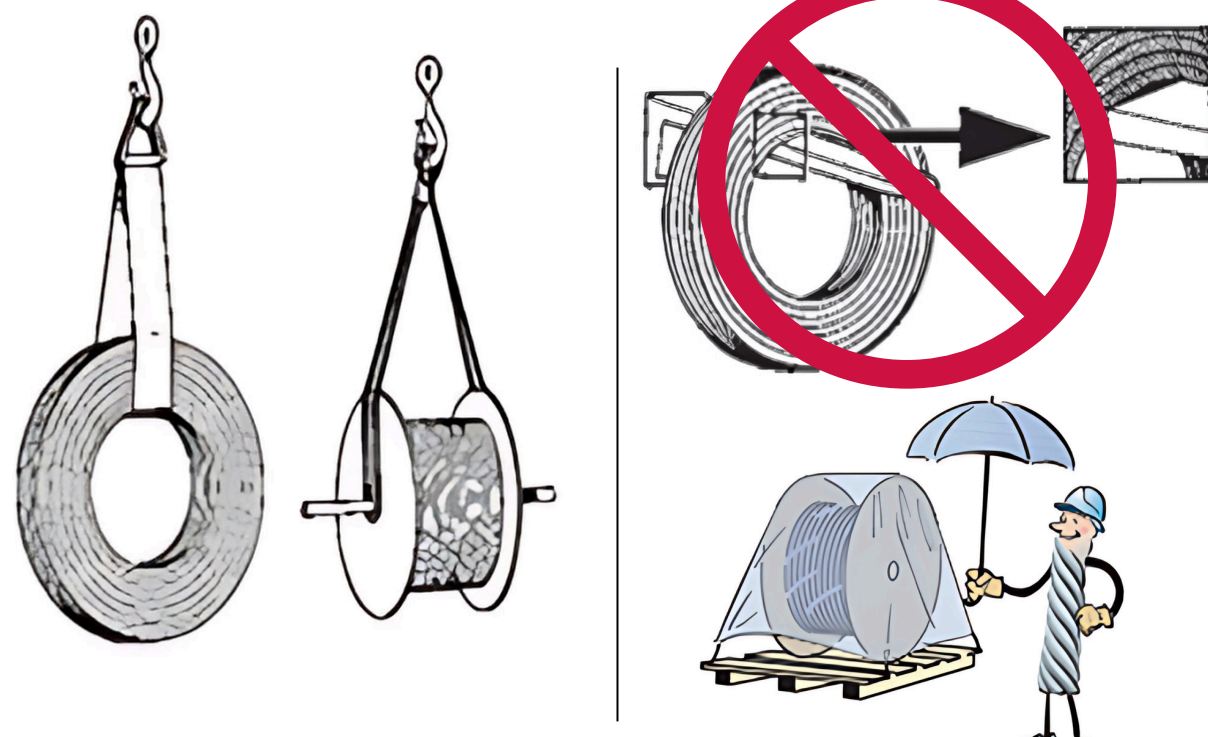

LIFTING, TRANSPORT, AND PROTECTION



UNWINDING THE STEEL WIRE ROPE

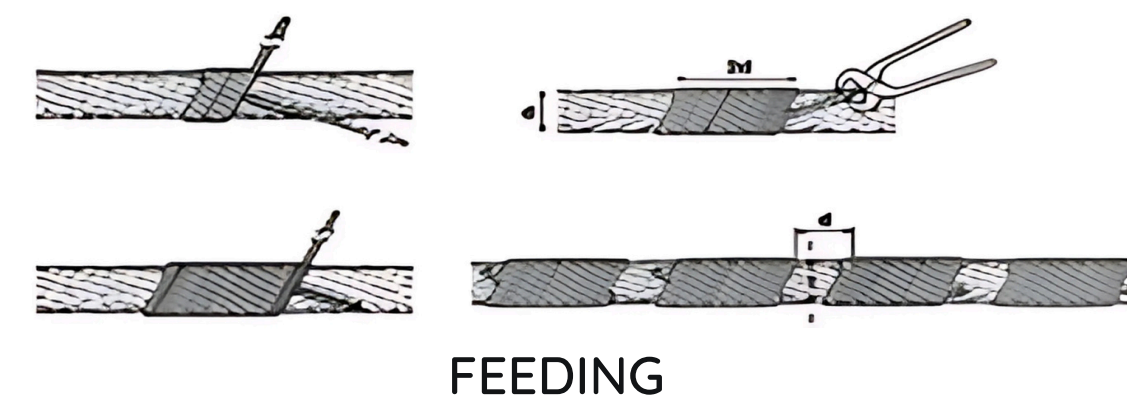

FEEDING

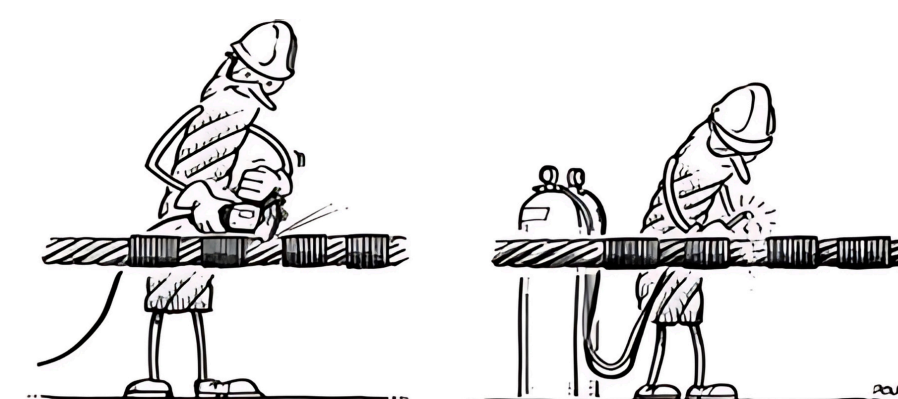

CUTTING

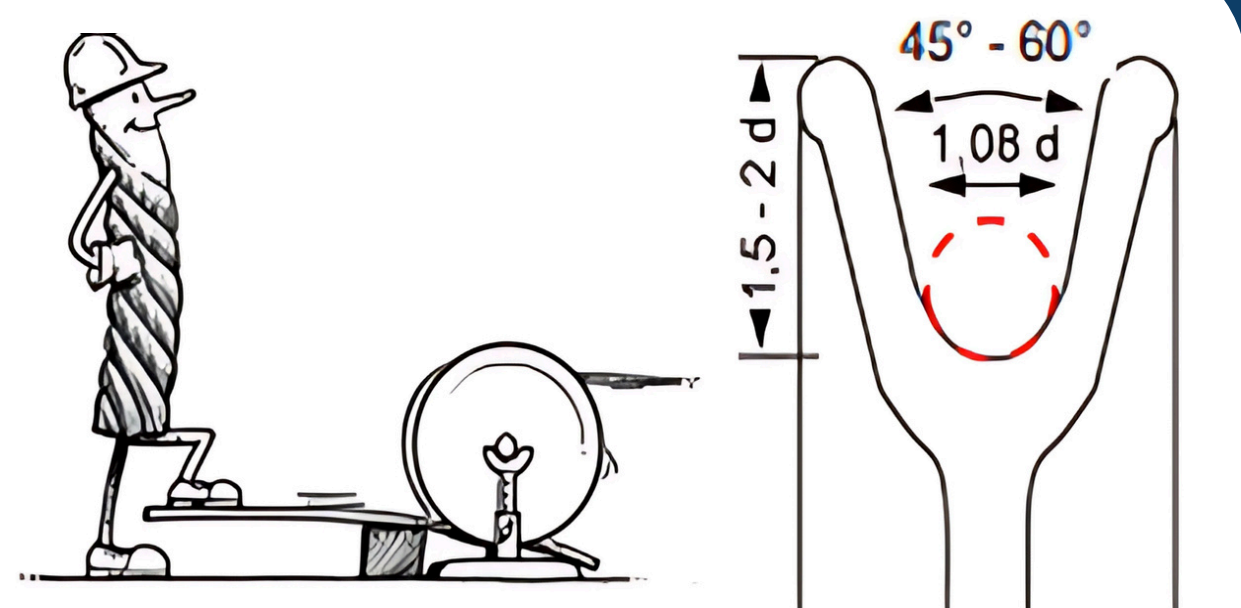

SHEAVE GROOVE DIAMETER AND SPACING

INSTALLATION

installation rope under tension, approximately 10% of the rope's nominal breaking load.

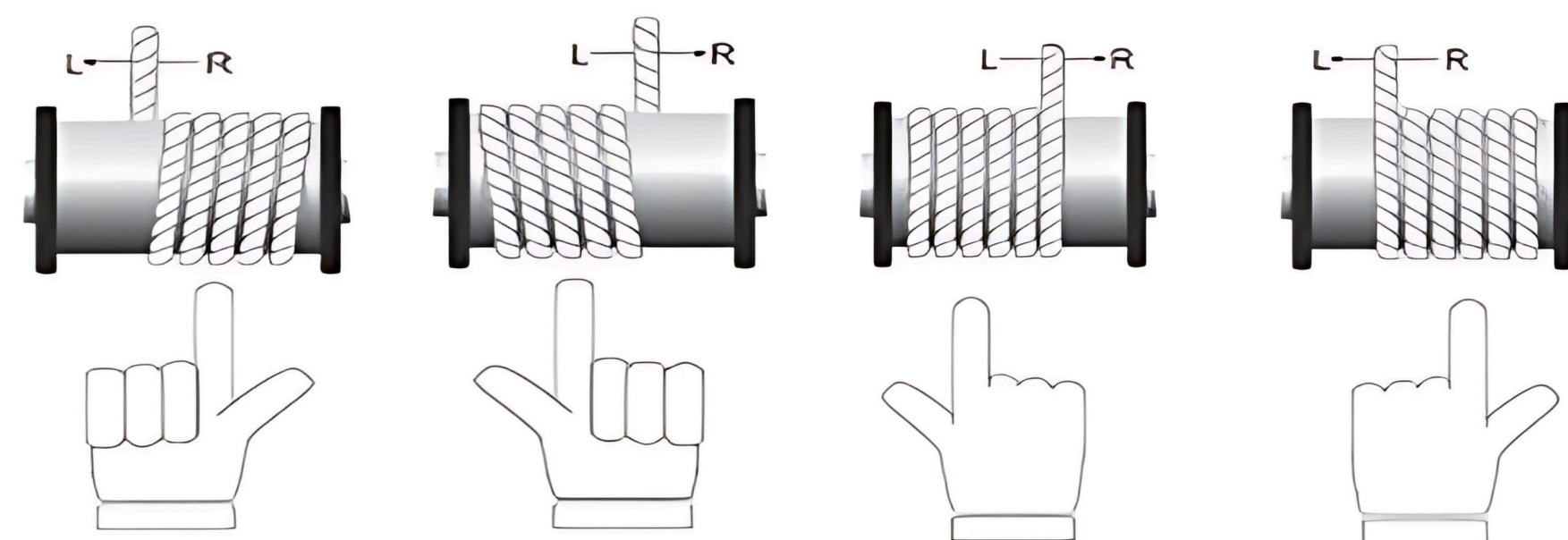

RIGHT-HAND LAY ROPE:
from right to left

LEFT-HAND LAY ROPE:
from left to right

RIGHT-HAND LAY ROPE:
from left to right

LINA UŁOŻONA LEWĄ RĘKĄ:
from right to left

LAYING DIRECTION



More information can be found in the manual available via the QR code.

CERTEX